

## 7, Corston Brompton Road, Weston-Super-Mare, North

Auction Guide Price +++ £130,000



- FOR SALE BY ONLINE AUCTION
- WEDNESDAY 14TH MAY 2025
- VIRTUAL TOUR NOW ONLINE
- VIEWINGS – REFER TO DETAILS
- DOWNLOAD FREE LEGAL PACK
- MAY LIVE ONLINE AUCTION
- END OF TERRACE HOUSE
- REQUIRES UPDATING
- GARDENS | SCOPE FOR PARKING
- EXTENDED 8 WEEK COMPLETION

Hollis Morgan – MAY LIVE ONLINE AUCTION – A Freehold END OF TERRACE 3 BED HOUSE ( 979 Sq Ft ) now in need of UPDATING | Front and Rear GARDEN - scope for PARKING.

# 7, Corston Brompton Road, Weston-Super-Mare, North Somerset, BS24 9BX

## Accommodation

### FOR SALE BY LIVE ONLINE AUCTION

ADDRESS | 7 Corston, Brompton Road, Weston-Super-Mare, North Somerset BS24 9BX

Lot Number TBC

The Live Online Auction is on Wednesday 14th May 2025 @ 17:30  
Registration Deadline is on Monday 12th May 2025 @ 16:00

The Auction will be streamed LIVE ONLINE via the Hollis Morgan website & you can choose to bid by telephone, proxy or via your computer. Registration is a simple online process – please visit the Hollis Morgan auction website and click “REGISTER TO BID”

### THE PROPERTY

A Freehold end of terrace 3 bedroom house with accommodation ( 979 Sq Ft ) arranged over two floors with front and rear gardens and outbuildings. Sold with vacant possession.

Tenure - Freehold  
Council Tax - Band B  
EPC - D

Utilities, Rights & Restrictions - Please refer to the Legal Pack  
Flood Risk - Please refer to the Legal Pack

### THE OPPORTUNITY

FREEHOLD INVESTMENT | HOME

The property has been previously let ( now vacant ) and would benefit from updating but offers scope for an excellent value home or investment in this sought after semi pedestrianised area.

There is potential to improve the rear extension and outbuildings to provide further accommodation.

Sold with vacant possession.

REAR GARDEN | PARKING

Similar properties have create off street parking in the rear garden. Subject to gaining the necessary consents.

### LOCATION

Weston Super Mare is a popular seaside town located on the Bristol Channel coast of North Somerset situated approximately 18 miles (29 km) south-west of Bristol and has a population of approximately 80,000 people. The town has a long history as a popular holiday destination, with a sandy beach that stretches for over two miles (3.2 km) and a variety of attractions and activities for visitors. The town centre has a mix of old and modern buildings, with several historic landmarks such as the Grand Pier, the Winter Gardens Pavilion, and the Birnbeck Pier. Westons main attraction is its beach, which is backed by a wide promenade and a range of amenities such as cafes, restaurants, and shops. The Grand Pier is a popular destination for families, with a variety of fairground rides, arcade games, and attractions. The town also has several parks and green spaces, including the 12-acre Grove Park, which has a children's play area, a boating lake, and a miniature railway. Other popular parks include Clarence Park and Ashcombe Park, both of which offer picturesque settings for picnics and walks. Weston is well connected with the M5 motorway running nearby and regular train services to Bristol, Bath, and other major cities. The town also has its own railway station, which is located within walking distance of the town center and the beach.

## Floor plan

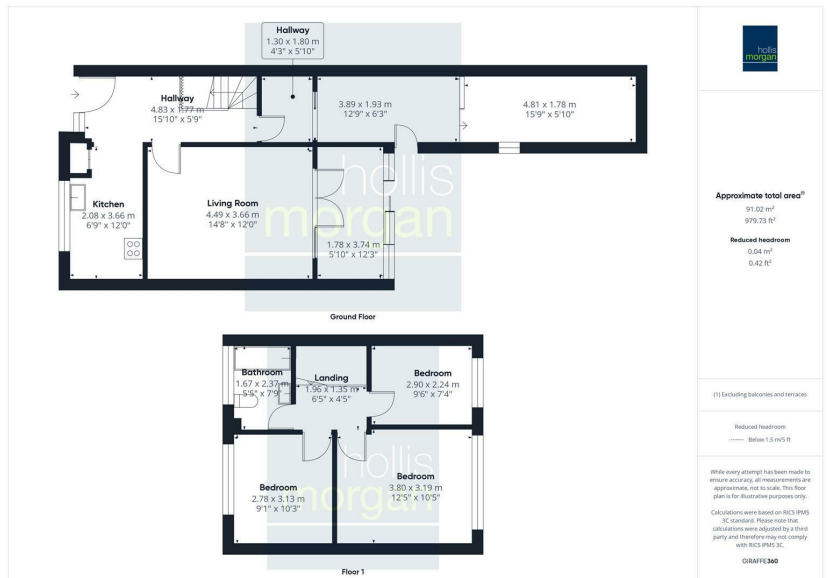

## EPC Chart

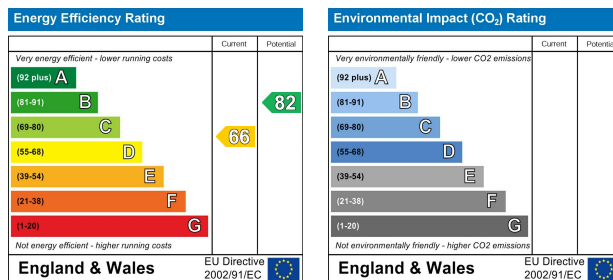

9 Waterloo Street  
Clifton  
Bristol  
BS8 4BT

Tel: 0117 973 6565  
Email: post@hollismorgan.co.uk  
www.hollismorgan.co.uk

Hollis Morgan Property Limited, registered in England, registered 7275716.  
Registered address, 5 Upper Belgrave Road, Clifton, Bristol BS8 2XQ

## Auction Property Details Disclaimer

Hollis Morgan endeavour to make our sales details clear, accurate and reliable in line with the Consumer Protection from Unfair Trading Regulations 2008 but they should not be relied on as statements or representations of fact.

Please refer to our website for further details.